

For more info, please download from <http://server.growatt.com>
 T +86 755 2747 1942 F +86 755 2747 2131
 E service@inverter.com W www.growatt.com

Step1. SIM card installation

Remove the rubber plug, and loss the screws. Open the cover, and take out the PCB board, and insert the SIM card. Put the PCB back to the cover, tighten the screw, and put back the rubber plug.

Note: 1. If the GPRS module with SIM card, no need above operation.
 2. No touch of other components during operation.

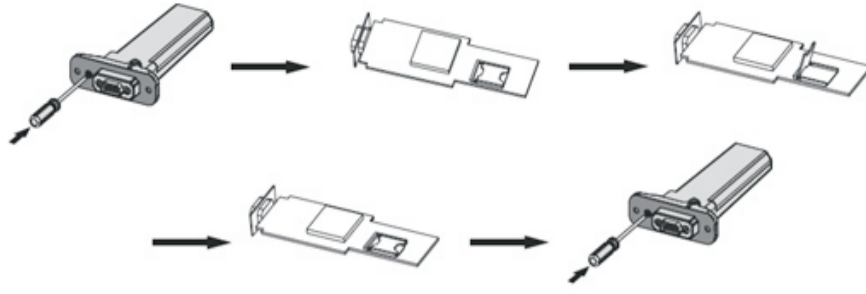

Step2. Connection between inverter and ShineGPRS module

Remove the RS-232 cover of the inverter, plug ShineGPRS to the RS-232 port:

- A If the inverter RS-232 port is like type A, switch the DIP1 switch to "ON", then connect ShineGPRS to the inverter RS-232 port, and fix it with the screws.
- B If the inverter RS-232 port is like type B, remove the rubber plug, then connect ShineGPRS to the inverter RS-232 port, and fix it with the screws.

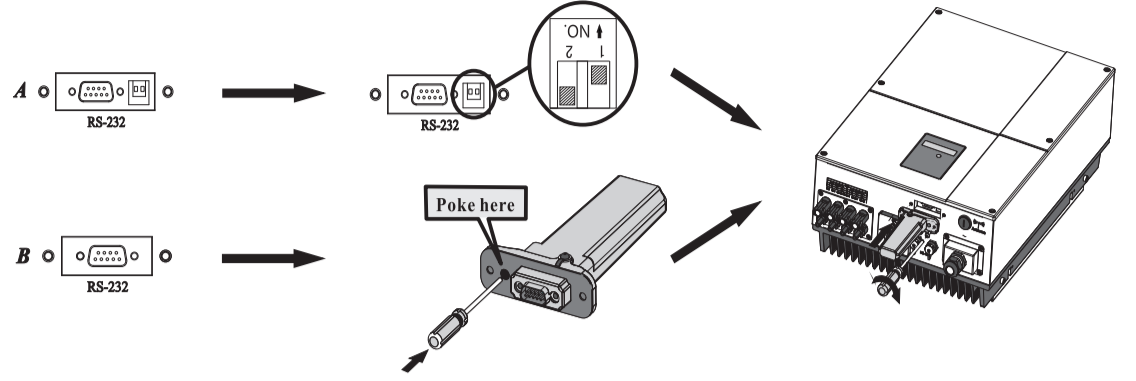

Step3. Turn on inverter and check ShineGPRS state

After install the ShineGPRS module, turn on the inverter, red LED flashing and blue LED flashing (change every 0.2 sec) indicates the inverter and ShineGPRS communication is normal.

| Blue LED state | Indication | Red LED state | Indication |
|-------------------------------------|---|--------------------|--|
| OFF | ShineGPRS not connected well with inverter RS232 port | OFF | Network communication part not working |
| Always ON | ShineGPRS initialization | 64ms ON 800ms OFF | Not found the network |
| Flashes fast (change every 0.2 sec) | ShineGPRS and inverter communication is OK | 64ms ON 3000ms OFF | Register to network |
| Flashes slow (Change every 1 sec) | ShineGPRS, network and inverter communication is OK | 64ms ON 300ms OFF | GPRS Network communication OK |

Step4. Registration and adding device

Scan the QR code below to download ShinePhone, also you can search ShinePhone in iOS or Google Play Store, download and install it.

Note: 1. Make sure you download the latest version;
 2. For further information please visit server.growatt.com.



【Android&iOS】

1. Open ShinePhone APP, click "Register" on login page.

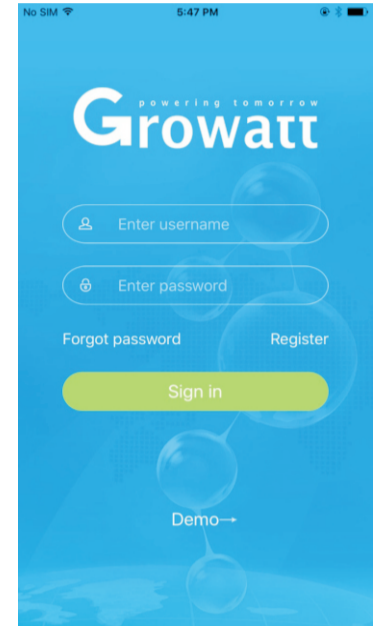

2. Select country and city, then click "Next" enter next page.
 Note: If you select a wrong country and city, the system time maybe wrong.

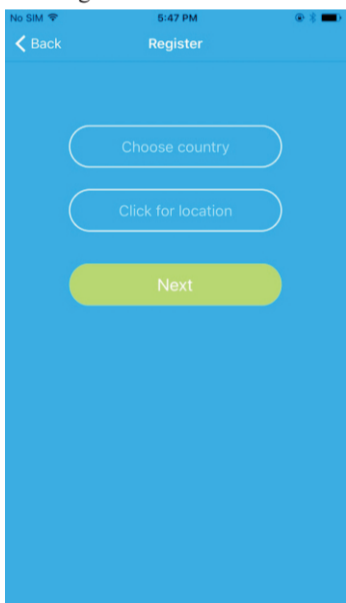

3. Fill out the required information, then click "Next", it will guide you to the "Add datalogger" page.

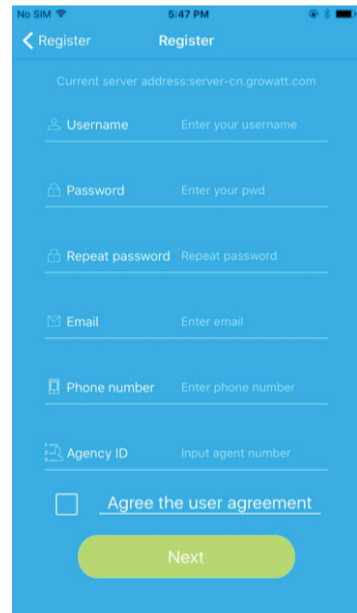

4. Scan or input the ShineGPRS barcode and checkcode, then click "Register", after register succeed, it will move you to the "my plant" page.

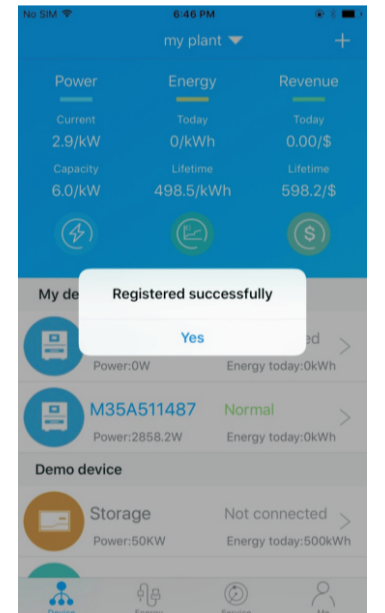
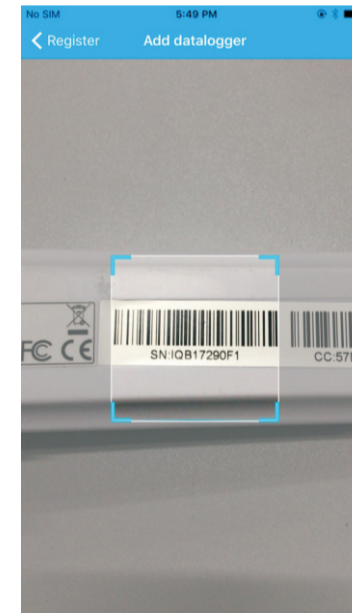
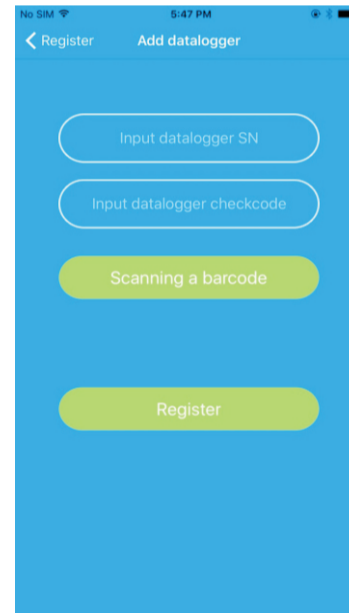

5. In "my plant" page, select the inverter in the device list to check the inverter update information.

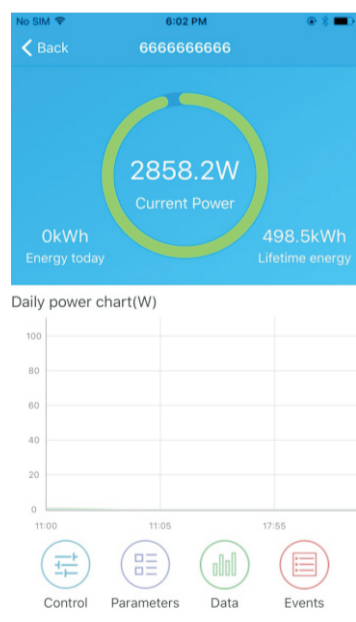

6. If you want to add/edit/delete/configure a datalogger, click the "+" sign on the right top side of the "my plant" page. There are 4 options in the dialog window when push on the datalogger's serial number, click the one you need.

Note: 1) After add ShineGPRS to server account, it will automatic communicate with Growatt server, you can remove the rubber plug on the KEY button to check the blue LED, when it turns from flash every 0.2 sec to flash every 1 sec, mean communication OK.
 2) If want change ShineGPRS to a new account, delete it from previous account first, then add it to new account.
 3) If want to set ShineGPRS to factory settings, remove the rubber plug, and press the KEY button for 6 sec until blue LED always ON.
 4) If want to restart ShineGPRS, short press the KEY button.

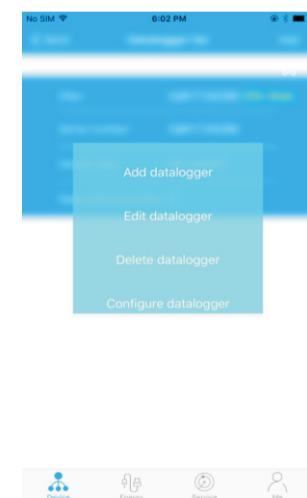
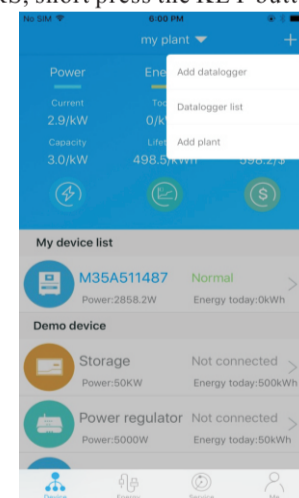

Appendix A Troubleshooting

| LED State | Indicate | Troubleshooting |
|---|---|---|
| ALL LED are OFF | ShineGPRS can not found the inverter via RS232 port | 1. Check if the DIP switch beside inverters RS232 port is switched DIP1 to "ON" 2. Try to reconnect ShineGPRS to the inverter RS232 port |
| Blue LED keeps flashing every 0.2 sec (0.2 sec ON, 0.2 sec OFF, As one cycle) | ShineGPRS not connect to Growatt Shine Server | 1. Not insert SIM card or SIM card not install well 2. ShineGPRS not add to Shine Server account 3. Server address wrong |
| Blue LED keeps flashing every 1 sec (1 sec ON, 1 sec OFF, As one cycle) | ShineGPRS, inverter and Growatt Shine Server communication OK | Normal working state |

